



---

**To the General Manager**

**Attach:** 1. Survey Results  
2. Proposed Parking Changes  
3. Map - Proposed Changes

---

**SUBJECT:** (4.5) North Sydney and Neutral Bay - Parking Area 1 – Survey Results

**AUTHOR:** Report of Parking Facilities and Operations Officer, Tram Nguyen

**DESCRIPTION/SUBJECT MATTER:**

A parking survey for **North Sydney and Neutral Bay Parking Area 1** was sent out on the 18 September 2020 to 1529 residents, businesses, property owners, and to Neutral, Anderson and Milson Precincts. Residents were given until 18 October 2020 to respond. A total of 104 responses were received. This represents a response rate of 6.8%, which is slightly below the average response rate of 10 to 12%.

The answers received from the residents for the Parking Area 1 survey are summarised in the report. Recommended changes to the parking restrictions in the Parking Area 1 are also detailed in the report.

**RECOMMENDATION:**

- 1. THAT** Council change the one (1) existing “1/2 Hour Parking 8.30am - 6pm Mon – Fri Permit Holders Excepted Area 1” parking space fronting property No. 19 Bray Street, North Sydney, to “2 Hour Parking 8.30am - 6pm Mon – Fri Permit Holders Excepted Area 1”.
- 2. THAT** Council remove the ‘mobility permit’ limitation from the opening sign for the two (2) parking spaces fronting property no. 62 Clark Road, North Sydney, to match the closing sign “2 Hour Parking 8.30am - 6pm Mon – Fri Permit Holders Excepted Area 1”.
- 3. THAT** Council change the six (6) existing “2 Hour Parking 8.30am - 6pm Mon – Fri Permit Holders Excepted Area 1” parking spaces between property no. 1 and 4 Margaret Street, North Sydney, on the southern side of Margaret Street Reserve, to “1/2 Hour Parking 8.30am - 6pm Mon – Fri Permit Holders Excepted Area 1”.
- 4. THAT** Council change the three (3) unrestricted parking spaces in The Avenue at the south eastern boundary of no. 32 Whaling Road, North Sydney, to “4 Hour Parking 8.30am - 6pm Mon – Fri Permit Holders Excepted Area 1”.
- 5. THAT** Council notify the residents before installing the parking restriction changes in North Sydney and Neutral Bay Parking Area 1.
- 6. THAT** Parking changes be implemented under delegation to the Manager Traffic & Transport Operations.
- 7. THAT** the new parking restrictions be reviewed six (6) months after the date of installation in North Sydney and Neutral Bay Parking Area 1.

**CONSULTATION REQUIREMENTS**

Consultation has been undertaken in accordance with Council's Community Engagement Protocol

**Relates to ECM No:** N/A

**Standard or Guideline Used:** AS2890.5; AS1742.11; NSC Resident Parking Permit Policy

**Signs & Lines Priority:** 2

**Precinct and Ward:** Neutral/Anderson/Milson, Victoria

**Impact on Bicycles:** Nil

**Impact on Pedestrians:** Nil

**Impact on Parking:** Some changes to parking restrictions are proposed as outlined in the report.

## **DETAIL**

Parking Area 1 includes Alfred Street North, Bray Street, Clark Road, Darley Street, Doris Street, High Street, Kurraba Road, Little Alfred Street, Margaret Street, Neutral Street, Ormiston Avenue, Rawson Street and Whaling Road.

A total of 1529 surveys were distributed to residents, property owners, businesses, and to the Neutral, Anderson and Milson Precincts on 18 September 2020. The survey was also available online. Residents were given until the 18 October 2020 to respond. A total of 104 responses were received, including 5 hard copy responses and 99 online responses. This represents a response rate of 6.8%, which is slightly below the average response rate of 10 to 12%.

A petition requesting changes to parking restrictions in Margaret Street was received with 18 signatures requesting that the 2 Hour Parking and unrestricted parking in Margaret Street be changed to 1/2 Hour Parking and 4 Hour Parking, respectively. Survey results indicate residents on Margaret street also generally support changes to the current restrictions.

A second petition supporting no changes to Area 1 parking restrictions was received with 141 signatures.

Due to the opposing nature of each of the two petitions, recommended changes in this report were based on survey responses from residents in individual streets and current occupancy data.

There is conflicting signage in Clark Road outside house no. 62. The opening sign currently reads “2 Hour Parking 8.30am - 6pm Mon - Fri Permit Holders with Mobility Permit Excepted Area 1” and the closing sign reads “2 Hour Parking 8.30am - 6pm Mon - Fri Permit Holders Excepted Area 1”. It is not known when or why this signage was installed; however, it appears to have been in place since 2007 at least. It is recommended that the “Mobility Permit” limitation be removed from the opening sign. Should Council subsequently receive any objections the matter can be reconsidered.

## **SURVEY RESULTS**

The responses received for North Sydney Parking Area 1 parking survey are summarised in Attachment 1.

### **Precinct Comments**

At the time of writing Council has not received comments from Neutral, Anderson or Milson Precincts.

## Comments Received

Respondents were asked to provide general comments/feedback as desired. Comments have been grouped by emerging themes.

## Petitions

- **18 signatures in support of changes to the current parking restrictions in Margaret Street – ‘Subject: Parking controls in Margaret Street, north Sydney’**

Dear Madam Mayor,

We, the residents of Margaret Street North Sydney and surrounds, hereby petition our Council to make changes to the parking restrictions in parts of our street.

The specific changes we seek are documented below.

### Context:

Within the community that has Area 1 parking stickers and who use the Margaret Street parking there are people with small babies and children, as well as older people and disabled residents. At the moment these people, and other residents, are often unable to park in this area during the day as it is full with people parking over the time limit.

This situation has been problematic for residents for some years and has recently become more acute.

We believe that our requested changes would not only address this problem, but also make it easier for Council’s rangers to adequately patrol the parking.

### Requested Changes:

- (1) That six (6) 90-degree parking spots at the upper (south) end of Margaret Street (between 1 Margaret Street and 2 Margaret Street) have their parking restrictions changed as follows:
    - From: the current “2P” parking (8:30am-6pm Mon-Fri, permit holders excepted Area 1)
    - To: “1/2P” parking (8:30am-6pm Mon-Fri, permit holders excepted Area 1)
  - (2) That the three (3) parallel parking spots at the southwest end of Margaret Street (near to Whaling Road, adjacent to 32 Whaling Road) have their parking restrictions changed as follows:
    - From: being currently unrestricted
    - To: “4P” parking (8:30am-6pm Mon-Fri, permit holders excepted Area 1)
- **141 signatures in support of no changes to the current parking restrictions in Area 1 – RE: Attached Petition objecting to changes to parking scheme for Area 1’**

Dear General Manager,

Over 130 residents living in Whaling Rd, Doris St, Neutral St and Little Alfred St – all part of Council’s designated parking Area 1 – have signed a petition objecting to Council installing parking meters and to the removal of the few remaining unrestricted parking places in the area. These unrestricted parking spots are required and greatly valued by residents and their visitors who either cannot afford or are ineligible for a parking permit because they do not comply with Council’s strict residents’ parking scheme. An example is where an adult son/daughter returns to live with the family and owns a car, a very common scenario exacerbated by Covid.

In discussions with people who signed this petition, it has also become clear that residents of some of the laneway-sized streets in Area 1 – for example, Margaret St and Bray St – have come together to try to find alternative solutions to parking issues in their streets. One suggestion from Bray St was to change the parking in Whaling Road to rear-to-curb parking. This is definitely not supported by residents in Whaling Rd due to safety concerns.

Residents in Margaret St are frustrated by a very slow-going construction project which has clogged parking in their area for many months. To alleviate the problem, they have focussed on the removal of the unrestricted parking. While the construction is slow, occupation by contractors on the site is temporary, unlike the removal of unrestricted parking, which is permanent.

One of the concerns consistently raised by local residents is the limited availability of temporary parking permits. We urge council to consider making both annual parking permits and temporary parking permits more available to residents.

While the residents accept that there are issues with parking in the area, they overwhelmingly do not support the introduction of parking meters, nor do they support the removal of any unrestricted parking spaces. They have signed this petition to support the current parking arrangements in the area. They have signed in support of no change.

We the undersigned residents of Whaling Road, Doris Street, and other nearby streets, wish to advise that current parking arrangements in our street are FINE JUST THE WAY THEY ARE.

We object to Council's intentions to:

- Install parking meters in our residential streets;
- View us, and our residential neighbourhood, as a revenue-producing extension of North Sydney CBD;
- Foist “CBD-style” and “one policy fits all” parking policies onto us;

Take away our few remaining all day parking spots, which benefit residents (and their visitors), especially those who may not be able to afford a parking permit, or who may object in principle to paying an annual fee for the privilege of parking in their own street.

### **Support Parking Restrictions**

- Unrestricted parking is being used a lot in our street by people who dump cars and people who have car parks at units and have more than one car or people who use their own garages for storage rather than parking. A simple solution is to limit the time for non-resident and ensure this is actually policed properly not just chalked and never revisited by parking rangers.
- 30 mins parking Margaret Street For all 2hr Parking.
- Replace some unrestricted with timed parking.
- Please remove unrestricted. Please also have more inspectors as many people on Doris St ignore the restrictions and park there during weekdays.
- Happy with the current arrangements on Alfred Street. Bray Street/ Neutral Street 1/2 hour is restrictive and should be increased to an hour, it is difficult to have trades/friends visit when 1/2 hour is in place.

- Less meter parking, and more timed parking.
- Remove unrestricted parking from outside homes with no personal driveway.
- Firstly, I feel that the parking in area 1 (actually in all areas) should benefit the residents over commuters. The streets that don't impact me personally, I cannot really comment on behalf of those residents...so I have answered with a "retain parking", when this may not be in their best interests. Given also, those residents aren't aware of the parking conditions in Darley Street, therefore, they cannot really comment with any knowledge of our concerns. There are also residents in Darley who have off-street parking, therefore I believe they may this survey relating to visitor parking. Area 1 is the closest to North Sydney CBD and has the commercial space along Alfred Street North near Mount Street, therefore we get frequent commuters in the 4-hour zone that overstay this period, who walk up into North Sydney. I feel introducing a 2-hour zone will increase the problem as most people who are looking for parking to conduct business in North Sydney look at the 1 hour and drive off. I propose 1 hour in all of Darley Street and a slight increase to the visitor parking permits to compensate. As Darley Street is on the limit of Area 1, I propose the 2-hour parking in Rawson, on both sides between Kurraba and Eaton, be turned into a shared Area 1/ Area 30. Otherwise, residents of Darley are then left to find parking quite some walk from their home. In light of the Warringah Freeway upgrade that is in the pipeline, parking will then need to be reviewed again as the EIS states that the construction workforce will need to find parking in residential streets, which will exacerbate the problem.
- New restrictions with resident permits.
- 1 Hour parking (not meter) between 8am and 8pm.
- Change everything that isn't half hour to half hour.
- I believe that 2 hour free parking in these areas is reasonable, as there are a lot of tradespeople who service this area.

### **Oppose Changes to Current Parking Restrictions**

- I believe the existing parking restrictions work perfectly satisfactorily. With our house in Neutral St, we use parking in Neutral, Bray and Kurraba. We do NOT experience any difficulty finding a spot when we need it, so the existing restrictions work perfectly well for our purposes. We see no evidence whatsoever of commuters using our area inappropriately.
- PLEASE can you leave the existing parking restrictions in place in Whaling Rd, Margaret St, Neutral St & Doris St.
- There should also be no changes to the limited unrestricted parking. This unrestricted parking is necessary for residents who have visitors, tradespeople or others with a vehicle that is excluded in the strict residents parking policy.
- Since the introduction of the 1/2 hour parking time restrictions in Whaling Road and Neutral Street, we have not had any difficulty in finding on-street parking and consider that this restricted time regime is working well and should be maintained.
- I would like current arrangements for parking to remain as is.
- This is pure money grabbing- leave the parking restrictions as is. There is no shortage of parking.

- There is never an issue getting a park at any time during the day on either street (Darley St or Rawson St). Since the council removed a lot of the all-day parks on Rawson St there is rarely many cars parked on the street. I understand some other areas in North Sydney may be struggling but this is not the case here. Please retain existing parking restrictions in this location.
- We strongly oppose any change to the parking restrictions in Margaret Street and Clark Road.

### **Support Metered Parking**

- Meter parking (Doris & Darley St).
- In general, I would like to see more consistency in parking restrictions across the area - so 2-hour meter parking most places except for 1/2-hour meter parking near retail areas.
- (In reference to High Street) Metered parking. Paint individual park space (as most vehicles are parked willy nilly occupying 2 spaces).
- Leave what is paid parking, as is.

### **Oppose Metered Parking**

- Please do not increase the amount of meter parking in parking area 1. There is not a substantial parking problem due to existing time restrictions. Meter parking reduces the amenity for residents who either cannot obtain a permit or have visitors over, and it is simply unnecessary in our area.
- Darley street is a heritage-listed street and should NEVER have metered parking.
- (In reference to Whaling Road) no meters.
- I would like to see 1-hour parking at the top of Margaret St that is currently 2 hour - I do not want parking meters.
- I strongly oppose introduction of any additional metered parking in Area 1.
- All my neighbours & I are extremely happy with the current situation & would be greatly distressed & inconvenienced were these to change to metered parking.
- I don't support installing meters in totally residential streets like Doris Street and most of Whaling Road-they are ugly and largely unnecessary and actually encourage non-residents.
- We do not want meter parking on our street!
- The idea of Metered Parking in a Heritage Conservation residential area is appalling and another example of continual encroachment into this area. Right up there with the Bayer Building in terms of lack of care or resolve by North Sydney council to look after residents in this area.
- It seems from the way this survey is skewed that the decision has already been made to take away "some" of the unrestricted parking spaces. These spaces are used, for a variety of reasons, by many residents. Yes, they are sometimes also taken by visitors to the area (including the occasional person who may work and not live in North Sydney), but this is an increasingly rare occurrence. If you would only come out of your bunker up in Miller Street, and come down and have a look, and maybe even talk

to us, you would see for yourselves. Council has been trying to whittle these vital spaces away from us and our visitors for at least the last 25 years. On the question of meters, we are fortunate enough to live in an especially beautiful enclave of "old Sydney". We do not want parking meters, and numbered spaces, detracting from our historic streetscape. Please keep your money making "one policy fits all" thinking to yourselves. No parking meters!

- I feel strongly that there should be NO additional parking meters. The area is conservation or heritage and parking meters in the streets will detrimentally affect the quality of the area. Furthermore, the introduction of parking meters would make the area appear like a business area or extension of the CBD. It is not. It is a residential area and needs to be respected as such.
- We don't need any more metered parking within this area, it is a pure money grab.
- Furthermore, the residential and heritage character of the Whaling Road Conservation Area would be severely compromised and its character fundamentally commercialised if parking meters were to be introduced into this Area. We do not support the introduction of parking meters into this Area.
- I do not want metered parking.
- We do not need parking meters in Doris street as no commuters ever park there because of the distance from the trains etc. & the short parking time restriction & There is usually always parking available in the daytime, just the evening that it becomes a problem.

### **Support to Retain 6pm Time Restriction**

- Finishing at 6.00pm means that people coming for dinner during the week can park without having to find metered parking or moving cars. There are usually places available in Alfred Street after 6.00pm.
- Please do NOT increase the end of the parking restriction times beyond 6pm.
- Why can't option 22 have "retain existing".
- I definitely want parking restriction 6pm expiry to remain.
- I think you have reduced some options for reply on certain question, such as question 22. Where is the option to state retain existing restrictions.
- re. question no.22 - I would like the parking restrictions to continue to expire at 6pm.
- For Q22 I would like to maintain restrictions that expire @6pm.
- Parking restrictions to 6pm is fine, we don't have problems after 6pm.
- There is no option in question 22 to NOT extend the 6pm time frame. Hopefully this is an oversight otherwise it would seem the survey is a tick a box exercise rather than a true consultation. I have not completed this question for this reason.
- Question 22. I would like the existing expiry time of restrictions to remain as 6pm.
- Question 22, I would prefer to see no extension to current parking restriction times. This was not offered as an option.
- PARKING RESTRICTIONS ONLY TO THE EXISTING 6.00PM.
- Happy with the 6pm restriction. Making it 8pm is not practical.

- I would like current parking restrictions to keep 6pm expiry as residents returning in their vehicles would still be disadvantaged by office workers.
- I feel parking restriction times should stay at 6pm not later.

#### **Other – Support to Extend Restriction Expiry Time**

- Please extend the timed hours to outside of working hours so residences can get a park when they get home from work. Make the hours of restricted parking long 8-8 or similar, 1 hour is fine.
- I would like parking restrictions to expire at 6.30 as often people will park at 4 pm knowing they have a good chance of not being booked.

#### **Other – Support for More Parking Permits or Extend Eligibility to Adjacent Area 30 Streets**

- In my view local residents ought to be able to purchase more parking permits than currently allocated.
- The better plan to increase parking availability in all these areas would be to ask all residents to reapply for their resident exempt stickers/vouchers. It is widely known that some residents are misusing the system to the detriment of all. Some addresses fail to notify Council when a second vehicle is sold & use this additional voucher for friends' visits. Some residents, who have recently moved into the area, continue to receive the original owners' renewal notice for a second vehicle in the postal system & illegally use this for themselves. Thank you for the opportunity to participate in your survey.
- I don't acknowledge that some residents can't have permits. All residents should have access to permits.
- We are a family of five adults with four cars. We are not eligible for any parking permits because we have two spaces - a single garage and a small driveway. We cannot get permits for our other two cars and this is a source of great frustration for us. We constantly juggle vehicles. It is not as simple as cutting down on our cars - our two sons both require cars for their work, as do we. Council's policy has not kept pace with the changing nature of families where grown-up children remain at home for much longer these days. Our children are early 20's and whilst they are saving for their own homes, I can't see them leaving any time soon. We should be able to apply for parking permits for their cars and we would be happy to pay. I have been to council's offices twice to ask what we can do and been told by staff that there's nothing I can do.
- I am concerned that as a long-term owner and resident I continue to have no access to any parking permits. I trust I receive an appropriate discount on my rates?! These moves by Council appear to be focused more on revenue raising than concern for property owners.
- (In reference to Darley Street) I live on the North-East edge of Area 1. I have written to the council in the past to request the extension of Area 1 into a section of Rawson St. north of Darley St., on the west side of Rawson St. This is currently Area 30 but it's usually empty of cars while Darley St is often full. Either extend Area 1 into that section of Rawson St or make it a dual Area 1/Area 30 zone. I was told this could not be done yet it has been done at the intersection of Darley and Rawson St. There is no sensible



reason it cannot be done. It's frustrating to turn into Darley St and find no spaces while there are plentiful spaces just round the corner obviously not needed by Area 30 residents. I was told by council that Area 30 residents requested more spaces at a resident parking meeting. I was at that meeting and Area 1 residents also asked for more. Regarding 4 hour spaces in Darley St - it would be better if they were located at the top of Darley St near Alfred St where there are fewer residents, Thank you.

- I would like the assurance of Council that my tenants would have access to residential stickers. I love the area and want to see it thrive.

#### **Other – Support for Line Marked Bays**

- Everyone is parking their company vehicles (e.g. moving vehicle) bikes etc. without being aware that they are taking 2 spaces instead of one. We need car spaces marked painted at High Street because it attracts drivers who work in the business section of NS & they leave their cars there all day. Please consider painting car spaces along High St & make it residential.
- In my view the parking situation is made worse by the following factors: residents without parking spaces in their properties who have 2-3 vehicles (cars + motor bikes); tradesmen on large jobs taking up multiple spaces over several weeks; large utes and vans which take up more than 1 car space; non-residents wanting to go to the harbour foreshore, particularly around Xmas/NY.
- (In reference to Doris St) 2 hr parking with painted lines showing cars where to park leaving room for further cars to park. Inconsiderate residents & visitors park so far apart taking up to car spaces. This is a problem everywhere in the area where there are no marked car spaces. It would free up the problem especially at night when people are returning home from work & extra parking spaces. Painted Marked spaces in all the little streets in Area 1 would create many more car parking spaces. I have lived here in Doris Street for 9 years & have observed that this would be a great solution to show people where they can park in between the lines. I know most of my neighbours feel the same with a few just wanting to park right outside their door & not moving up or back to the next car leaving a whole car space for someone else.

#### **Other – Support for Increased Ranger Patrols**

- Regular patrols of parking would also be useful. Parking has become increasingly difficult recently. There is however trends which correspond to the change in tenants who have different parking needs. Over the years there have been cycles depending on who is living there at the time and their parking needs.
- All areas need rangers monitoring on a regular basis and consider allowing more visitor parking for residents.
- It doesn't matter what the restrictions are, if they are not monitored then they are not working. The parking down Margaret street only gets looked at whenever I call.
- There are 23 unrestricted spots in Whaling, Doris and Margaret streets. On 1 last look 5 only had resident stickers and most non-resident vehicles have been in situ for longer than a month! Parking issues for residents seem to only be a real issue at night. Plenty of local parking during the day. I know that several residents at 22 Doris St apartments rent out their car spots as the come home after 6 and can park on the street. Not sure how you can stop this.

---

### **Other – Support for Unrestricted Parking**

- (In reference to Darley Street) Please increase the amount of two hour and unrestricted parking available.
- retain ALL unrestricted parking spaces. Most of the time, unrestricted parking spaces are used by residents, some of whom are ineligible for resident permits. Why is retaining ALL unrestricted parking spaces not an option in this survey?

### **Other – Support for Resident Only Parking**

- Make parking on High St resident only all the time.
- Alfred Street North to have 'Area 1 residents only' parking.
- (In reference to Doris St) Permit holders only. Always hard to find parking.

### **Other – Support for Parking on the Verge**

- Allow parking on verge where practical. Add diagonal parking in Whaling Rd where practical. Marking Little Alfred St one way leading to 4 Ormiston up to 1 Ormiston direction.
- Due to the constant possibility of a head-on collision, can traffic be made one-way entering from Whaling Road into Little Alfred Street and along Ormiston Avenue. Could we have more frequent ranger visits to Area 1. Where possible in the wider sections of Whaling Road - could additional parking be added using diagonal parking? Can proper parking spaces be indicated on the streets to stop vehicles taking up 2 spaces for one car? This is often a problem in Bray street which only has 2 spaces and along upper Neutral Street. Allow parking on verge where practical in upper Neutral Street.

### **Other**

- As the Western Harbour tunnel development progresses, and traffic along Alfred Street North will greatly increase, is there any point in altering the current situation?
- It would be beneficial to have uniformity of parking across the area because all the different restrictions are confusing.
- This survey does not appear to be putting the rate payers/residents to the forefront in the decisions. It appears this is for revenue raising!
- I find there is a good balance of restricted/unrestricted/metered/non-metered parking in this area and the parking rangers are active enough in the area to discourage anyone from overstaying/ going past their metered time etc. Further due to the covid pandemic and increase of office workers working from home there has been a significant increase in available parking.
- Thanks for letting us have a say.
- Please don't make it harder for visitors to come to our place. half hour parking does not allow any visitor time so we need the variations.
- Introduce angle parking in suitable spots on Whaling Rd. Make Little Alfred St and Ormiston St one way from Neutral St end. not enough room to pass on Neutral St. Avoid trucks entering from Whaling Rd end because they can't negotiate sharp corner at the end and unsighted parts of the road near Ormiston St corner.

- Council is considering allowing more developments in the tiny Whaling Rd/Neutral St precinct, bringing a lot more traffic and more parking permits for residents. The situation in terms of parking and leaving the precinct is already dire. The problem is the only access to the world from this area is off Whaling Road onto Alfred Street. Here are the issues:
  - A. It is very difficult now for the 160 existing street residents in the area plus the residents of Glenn-Ormiston high-rise (which had its own private parking garages) plus the residents of the highrise at the east end of Whaling Road to leave the area in the mornings and evenings as it is. What will happen when additional residents are added to the existing frustration of entering Alfred Street off Whaling Road?
  - B. All traffic entering High Street from the North Sydney CBD has the right of way over traffic on Alfred Street. There is a traffic light at Mount Street and Alfred Street that permits traffic leaving the NS CBD to enter Alfred Street before Whaling Road. All this traffic jams back to permit traffic on High Street. Now, the residents from the area must try to push their way off of Whaling Road onto Alfred Street. It is bad enough now. If a new traffic light is put in at Whaling Road, it won't help because the traffic on Alfred street is blocked from entering High Street. Imagine what it will be like any more residents trying to go to work with the only exit from the area being Whaling Road?
  - C. We need parking rangers in the Whaling Rd/Neutral St precinct every weekday to start to make a difference to the parking situation.
  - D. Residents should only have one parking permit per property at a maximum.
  - E. Any new development (e.g. the Bayer Building replacement) should not entitle those new residents to any parking permit. This way, the buyers will all use public transport. This should apply to any new development in this precinct.
  - F. No mention is made in your survey of the lower half of Neutral St. This area is a nightmare to park in.
  - G. Lines could be marked for each parking space. This way thoughtless people who park in the middle of a longer area taking up two spaces could be booked.
  - H. Little Alfred St should be a one-way street. This street is dangerous with a steep hill in Ormiston St blocking the view. There are lots of near accidents, including of pedestrians.
  - I. All parking should be a maximum of 30 minutes for each weekday in the Whaling Rd/Neutral St precinct.
  - K. Residents should still be able to buy visitor parking permits.
- I refer to the above survey which closed yesterday. Unfortunately, I have not been able to put in my comments in time. I hope it's not too late for you to consider the following points as part of the survey.

We have lived in Darley Street for the past 20 years and I'm not convinced that the parking situation has worsened during that recent times. It has always been an issue. It is true that most of the difficulties for residents are caused by office workers from nearby North Sydney looking to park their cars. I don't see why we need to accommodate this need for people who are out of area and there are already other streets that offer metered parking for workers.

We need to be conscious that residents have visitors or trades people frequenting their homes throughout the week, particularly in this environment during the pandemic where most people are still working remotely. Therefore, I am concerned that by imposing reduced unpaid parking times, or paid metered spaces, this causes a problem for residents. One side of Darley Street currently has a 4-hour limit which accommodates visitors and trades people very well.

I don't see why I should have to pay for parking vouchers - each year - to accommodate visitors and tradespeople. I already pay significant council rates and why should residents of the street have the peace of mind to know that they can park somewhere near their home if they don't have off street parking.

We need to work out a way to stop office workers from North Sydney using these parking spaces as that is the main problem. One way to do this could be to introduce electronic meeting sensors or to increase the monitoring of parking by parking ranges. But I understand the latter option is probably less realistic.

## **DISCUSSION**

The survey results indicate some level of support for timed parking restrictions in Bray Street and Margaret Street. There was strong support for the 6pm expiry time to be retained, with 15 comments specifically requesting 6pm expiry time to be retained. Detailed recommendations based on the survey responses are listed in Attachment 2. Overall, there was a strong opposition to parking meters in Area 1 and as such no additional parking meters have been recommended in Area 1.

## PARKING RESTRICTION REVIEW – SURVEY RESULTS

Note: with exception of online questions 6, 9 and 14, any new restrictions proposed, including metered parking will have 'resident parking permit holders excepted Area 1'.

**3. In ALFRED STREET NORTH between Eaton Street & Kurraba Road,**  
I am in favour of replacing the existing 1 Hour Parking, 2 Hour Parking and some of the unrestricted parking with (choose one):

Respondent Type	2 Hour Parking		2 Hour METER Parking		Other - 1 Hour Parking		Retain existing parking restrictions		No answer		Grand Total	
	Number	%	Number	%	Number	%	Number	%	Number	%	Number	%
<b>Resident</b>												
Alfred Street North			2	29%			5	71%			7	7%
Bray Street							6	100%			6	6%
Clark Road	3	30%	1	10%			1	10%	5	50%	10	10%
Darley Street	1	7%	2	14%	1	7%	3	21%	7	50%	14	13%
Doris Street	1	11%	1	11%			6	67%	1	11%	9	9%
High Street	1	14%	3	43%			3	43%			7	7%
Kurraba Road	1	25%					2	50%	1	25%	4	4%
Margaret Street	1	11%	1	11%					7	78%	9	9%
Neutral Street			2	40%			2	40%	1	20%	5	5%
Ormiston Avenue							1	100%			1	1%
Whaling Road			1	6%	1	6%	10	56%	6	33%	18	17%
	8	9%	13	14%	2	2%	39	43%	28	31%	90	87%
<b>Business owner</b>							2	100%			2	2%
<b>Non-resident, owner</b>			5	63%			1	13%	2	25%	8	8%
<b>Non-resident, employee</b>							1	100%			1	1%
<b>Non-resident, visitor</b>									1	100%	1	1%
<b>Resident outside of area</b>							1	50%	1	50%	2	2%
<b>Grand Total</b>	<b>8</b>	<b>8%</b>	<b>18</b>	<b>17%</b>	<b>2</b>	<b>2%</b>	<b>44</b>	<b>42%</b>	<b>32</b>	<b>31%</b>	<b>104</b>	<b>100%</b>

**4. In ALFRED STREET NORTH between Eaton Street & Kurraba Road,**  
I am in favour of replacing the existing 1 Hour METER Parking with (choose one):

Respondent Type	1 Hour Parking		Other		Retain existing parking restrictions		No answer		Grand Total	
	Number	%	Number	%	Number	%	Number	%	Number	%
<b>Resident</b>										
Alfred Street North			1	14%	6	86%			7	7%
Bray Street					6	100%			6	6%
Clark Road					5	50%	5	50%	10	10%
Darley Street			1	7%	5	36%	8	57%	14	13%
Doris Street					8	89%	1	11%	9	9%
High Street					7	100%			7	7%
Kurraba Road					3	75%	1	25%	4	4%
Margaret Street					2	22%	7	78%	9	9%
Neutral Street					4	80%	1	20%	5	5%
Ormiston Avenue					1	100%			1	1%
Whaling Road	1	6%			11	61%	6	33%	18	17%
	1	1%	2	2%	58	64%	29	32%	90	87%
<b>Business owner</b>					2	100%			2	2%
<b>Non-resident, owner</b>					5	63%	3	38%	8	8%
<b>Non-resident, employee</b>					1	100%			1	1%
<b>Non-resident, visitor</b>							1	100%	1	1%
<b>Resident outside of area</b>	1	50%					1	50%	2	2%
<b>Grand Total</b>	<b>2</b>	<b>2%</b>	<b>2</b>	<b>2%</b>	<b>66</b>	<b>63%</b>	<b>34</b>	<b>33%</b>	<b>104</b>	<b>100%</b>

## Area 1 – Survey Results

5. In ALFRED STREET NORTH between Eaton Street & Kurraba Road,  
I am in favour of replacing the existing 9 Hour METER Parking with (choose one):

Respondent Type	Other				Retain existing parking restrictions	No answer		Grand Total	
	1 Hour Parking	2 Hour METER Parking	4 Hour METER Parking	Other - see comments		Number	%	Number	%
<b>Resident</b>	Number %	Number %	Number %	Number %	Number %		Number %	Number %	
Alfred Street North		2 29%			5 71%		7 7%		
Bray Street					6 100%		6 6%		
Clark Road					5 50%	5 50%	10 10%		
Darley Street	1	1 7%			7 50%	5 36%	14 13%		
Doris Street		1 11%			7 78%	1 11%	9 9%		
High Street				1 14%	6 86%		7 7%		
Kurraba Road					2 50%	2 50%	4 4%		
Margaret Street		1 11%			1 11%	7 78%	9 9%		
Neutral Street			1 20%		3 60%	1 20%	5 5%		
Ormiston Avenue					1 100%		1 1%		
Whaling Road	1 6%				10 56%	7 39%	18 17%		
	2 2%	5 6%	1 1%	1 1%	53 59%	28 31%	90 87%		
<b>Business owner</b>					2 100%		2 2%		
<b>Non-resident, owner</b>					6 75%	2 25%	8 8%		
<b>Non-resident, employee</b>					1 100%		1 1%		
<b>Non-resident, visitor</b>						1 100%	1 1%		
<b>Resident outside of area</b>					1 50%	1 50%	2 2%		
<b>Grand Total</b>	<b>2 2%</b>	<b>5 5%</b>	<b>1 1%</b>	<b>1 1%</b>	<b>63 61%</b>	<b>32 31%</b>	<b>104 100%</b>		

6. In ALFRED STREET NORTH between Kurraba Road & High Street,  
I am in favour of replacing the existing 1 Hour METER Parking and 2 Hour METER Parking with (choose one):

Respondent Type	2 Hour METER Parking		Other - 1 Hour Parking		Retain existing parking restrictions		No answer		Grand Total	
	Number	%	Number	%	Number	%	Number	%	Number	%
<b>Resident</b>	Number	%	Number	%	Number	%	Number	%	Number	%
Alfred Street North	2	29%			5	71%			7	7%
Bray Street	1	17%			5	83%			6	6%
Clark Road	3	30%			2	20%	5	50%	10	10%
Darley Street	2	14%			6	43%	6	43%	14	13%
Doris Street	3	33%			5	56%	1	11%	9	9%
High Street	2	29%			5	71%			7	7%
Kurraba Road	1	25%			2	50%	1	25%	4	4%
Margaret Street	1	11%			1	11%	7	78%	9	9%
Neutral Street					4	80%	1	20%	5	5%
Ormiston Avenue					1	100%			1	1%
Whaling Road	2	11%	1	6%	9	50%	6	33%	18	17%
	17	19%	1	1%	45	50%	27	30%	90	87%
<b>Business owner</b>	1	50%			1	50%			2	2%
<b>Non-resident, owner</b>	4	50%			3	38%	1	13%	8	8%
<b>Non-resident, employee</b>	1	100%							1	1%
<b>Non-resident, visitor</b>							1	100%	1	1%
<b>Resident outside of area</b>					1	50%	1	50%	2	2%
<b>Grand Total</b>	<b>23 22%</b>	<b>22%</b>	<b>1 1%</b>	<b>1%</b>	<b>50 48%</b>	<b>48%</b>	<b>30 29%</b>	<b>29%</b>	<b>104 100%</b>	

## Area 1 – Survey Results

7. In BRAY STREET between Alfred Street North & Neutral Street,  
I am in favour of replacing the existing 1/2 Hour Parking with (choose one):

Respondent Type	1 Hour Parking		2 Hour Parking		Other - 1 Hour METER Parking		Retain existing parking restrictions		No answer		Grand Total	
	Number	%	Number	%	Number	%	Number	%	Number	%	Number	%
<b>Resident</b>												
Bray Street	1	17%	2	33%			3	50%		0%	6	6%
Alfred Street North					1	14%	3	43%	3	43%	7	7%
Clark Road	1	10%	3	30%			1	10%	5	50%	10	10%
Darley Street	2	14%					5	36%	7	50%	14	13%
Doris Street			2	22%			7	78%			9	9%
High Street			1	14%			6	86%			7	7%
Kurraba Road			1	25%			2	50%	1	25%	4	4%
Margaret Street							2	22%	7	78%	9	9%
Neutral Street					1	20%	4	80%			5	5%
Ormiston Avenue							1	100%			1	1%
Whaling Road	3	17%	2	11%			6	33%	7	39%	18	17%
	7	8%	11	12%	2	2%	40	44%	30	33%	90	87%
<b>Business owner</b>			2	100%							2	2%
<b>Non-resident, owner</b>	2	25%	2	25%			2	25%	2	25%	8	8%
<b>Non-resident, employee</b>			1	100%							1	1%
<b>Non-resident, visitor</b>									1	100%	1	1%
<b>Resident outside of area</b>			1	50%					1	50%	2	2%
<b>Grand Total</b>	<b>9</b>	<b>9%</b>	<b>17</b>	<b>16%</b>	<b>2</b>	<b>2%</b>	<b>42</b>	<b>40%</b>	<b>34</b>	<b>33%</b>	<b>104</b>	<b>100%</b>

8. In CLARK ROAD between no. 62 Clark Road & High Street,  
I am in favour of replacing the existing 2 Hour Parking and some of the unrestricted parking with (choose one):

Respondent Type	Other				Retain existing parking restrictions	No answer	Grand Total				
	2 Hour Parking	1 Hour METER Parking	2 Hour METER Parking	Other - see comments							
	Number	%	Number	%	Number	%	Number	%	Number	%	
<b>Resident</b>											
Clark Road					7	70%	3	30%	10	10%	
Alfred Street North				2	29%	2	29%	3	43%	7	7%
Bray Street					5	83%	1	17%	6	6%	
Darley Street					7	50%	6	43%	14	13%	
Doris Street	1	11%			7	78%			9	9%	
High Street			1	14%	1	14%			7	7%	
Kurraba Road				2	29%	3	43%			7	7%
Margaret Street	1	11%			2	50%	2	50%	4	4%	
Neutral Street					3	33%	5	56%	9	9%	
Ormiston Avenue					4	80%	1	20%	5	5%	
Whaling Road					1	100%			1	1%	
	2	2%	1	1%	12	67%	6	33%	18	17%	
	2	2%	1	1%	4	4%	3	3%	53	59%	
<b>Business owner</b>					2	100%			2	2%	
<b>Non-resident, owner</b>					1	13%	6	75%	1	13%	
<b>Non-resident, employee</b>					1	100%			8	8%	
<b>Non-resident, visitor</b>									1	1%	
<b>Resident outside of area</b>									1	50%	
<b>Grand Total</b>	<b>2</b>	<b>2%</b>	<b>1</b>	<b>1%</b>	<b>4</b>	<b>4%</b>	<b>4</b>	<b>4%</b>	<b>63</b>	<b>61%</b>	
									<b>30</b>	<b>29%</b>	
									<b>104</b>	<b>100%</b>	

Area 1 – Survey Results

9. In CLARK ROAD between no. 64 & no. 66 Clark Road,

I am in favour of replacing the existing 1/4 Hour Parking and 1/2 Hour Parking with (choose one):

Respondent Type	1/2 Hour METER Parking		Other		2 Hour Parking		1 Hour METER Parking		Retain existing parking restrictions		No answer		Grand Total	
	Number	%	Number	%	Number	%	Number	%	Number	%	Number	%	Number	%
<b>Resident</b>														
Clark Road	3	30%							3	30%			4	40%
Alfred Street North									4	57%			3	43%
Bray Street	2	33%							4	67%				7
Darley Street	2	14%							7	50%			5	36%
Doris Street	2	22%							7	78%				9
High Street	1	14%							6	86%				7
Kurraba Road									3	75%			1	25%
Margaret Street									4	44%			5	56%
Neutral Street	1	20%							3	60%			1	20%
Ormiston Avenue									1	100%				1
Whaling Road	4	22%	1	6%					7	39%			6	33%
	15	17%	1	1%					49	54%			25	28%
<b>Business owner</b>	1	50%							1	50%				2
<b>Non-resident, owner</b>	2	25%					1	13%	3	38%			2	25%
<b>Non-resident, employee</b>									1	100%				1
<b>Non-resident, visitor</b>													1	100%
<b>Resident outside of area</b>									1	50%			1	50%
<b>Grand Total</b>	<b>18</b>	<b>17%</b>	<b>1</b>	<b>1%</b>	<b>1</b>	<b>1%</b>	<b>1</b>	<b>1%</b>	<b>55</b>	<b>53%</b>	<b>29</b>	<b>28%</b>	<b>104</b>	<b>100%</b>



Area 1 – Survey Results

10. In DARLEY STREET between Alfred Street North & Rawson Street,

I am in favour of replacing the existing 1 Hour Parking, 4 Hour Parking and some of the unrestricted parking with (choose one):

Respondent Type	2 Hour Parking		4 Hour Parking		4 Hour METER Parking		1 Hour Parking		2 Hour METER Parking		Other - see comments		Retain existing parking restrictions	No answer	Grand Total			
	Number	%	Number	%	Number	%	Number	%	Number	%	Number	%			Number	%	Number	%
<b>Resident</b>																		
Darley Street	1	7%	1	7%	1	7%	3	21%	1	7%	3	21%	4	29%		14	13%	
Alfred Street North					1	14%							3	43%	3	43%	7	6%
Bray Street			1	17%									5	83%		6	6%	
Clark Road	2	20%	1	10%							1	11%	2	20%	5	50%	10	10%
Doris Street	3	33%											5	56%		9	9%	
High Street	1	14%											6	86%		7	7%	
Kurraba Road													3	75%	1	25%	4	4%
Margaret Street													2	22%	7	78%	9	9%
Neutral Street													4	80%	1	20%	5	5%
Ormiston Avenue													1	100%		1	1%	
Whaling Road	1	6%											9	50%	8	44%	18	17%
	8	9%	3	3%	2	2%	3	3%	1	1%	4	4%	44	49%	25	28%	90	87%
<b>Business owner</b>					1	50%							1	50%		2	2%	
<b>Non-resident, owner</b>	2	25%			3	38%							1	13%	2	25%	8	8%
<b>Non-resident, employee</b>			1	100%												1	1%	
<b>Non-resident, visitor</b>													1	100%		1	1%	
<b>Resident outside of area</b>													2	100%		2	2%	
<b>Grand Total</b>	<b>10</b>	<b>10%</b>	<b>4</b>	<b>4%</b>	<b>6</b>	<b>6%</b>	<b>3</b>	<b>3%</b>	<b>1</b>	<b>1%</b>	<b>4</b>	<b>4%</b>	<b>49</b>	<b>47%</b>	<b>27</b>	<b>26%</b>	<b>104</b>	<b>100%</b>

## Area 1 – Survey Results

### 11. In DORIS STREET between Ormiston Avenue & Whaling Road,

I am in favour of replacing the existing 1 Hour Parking and some of the unrestricted parking with (choose one):

Respondent Type	Other				Retain existing parking restrictions	No answer	Grand Total
	1/2 Hour Parking	1 Hour Parking	2 Hour Parking	Other - see comments			
	Number %	Number %	Number %	Number %	Number %	Number %	Number %
<b>Resident</b>							
Doris Street		2 22%	1 11%	2 22%	4 44%		9 9%
Alfred Street North					4 57%	3 43%	7 7%
Bray Street					6 100%		6 6%
Clark Road		1 10%			4 40%	5 50%	10 10%
Darley Street		1 7%	1 7%		5 36%	7 50%	14 13%
High Street		1 14%			5 71%	1 14%	7 7%
Kurraba Road					3 75%	1 25%	4 4%
Margaret Street	1 11%				1 11%	7 78%	9 9%
Neutral Street		1 20%			4 80%		5 5%
Ormiston Avenue	1 100%						1 1%
Whaling Road		1 6%	1 6%		14 78%	2 11%	18 17%
	2 2%	7 8%	3 3%	2 2%	50 56%	26 29%	90 87%
<b>Business owner</b>					2 100%		2 2%
<b>Non-resident, owner</b>				1 13%	5 63%	2 25%	8 8%
<b>Non-resident, employee</b>					1 100%		1 1%
<b>Non-resident, visitor</b>						1 100%	1 1%
<b>Resident outside of area</b>					1 50%	1 50%	2 2%
<b>Grand Total</b>	<b>2 2%</b>	<b>7 7%</b>	<b>3 3%</b>	<b>3 3%</b>	<b>59 57%</b>	<b>30 29%</b>	<b>104 100%</b>

### 12. In HIGH STREET between Alfred Street North & Clark Road,

I am in favour of replacing the existing 2 Hour Parking with (choose one):

Respondent Type	Other			Retain existing parking restrictions	No answer	Grand Total
	4 Hour Parking	1 Hour METER Parking	Other - see comments			
	Number %	Number %	Number %	Number %	Number %	Number %
<b>Resident</b>						
High Street			1 14%	5 71%	1 14%	7 7%
Alfred Street North				4 57%	3 43%	7 7%
Bray Street	2 33%			4 67%		6 6%
Clark Road	1 10%			4 40%	5 50%	10 10%
Darley Street				8 57%	6 43%	14 13%
Doris Street	1 11%			7 78%	1 11%	9 9%
Kurraba Road				3 75%	1 25%	4 4%
Margaret Street			1 11%	3 33%	5 56%	9 9%
Neutral Street				4 80%	1 20%	5 5%
Ormiston Avenue				1 100%		1 1%
Whaling Road	3 17%			10 56%	5 28%	18 17%
	7 8%		2 2%	53 59%	28 31%	90 87%
<b>Business owner</b>	2 100%					2 2%
<b>Non-resident, owner</b>	1 13%	1 13%		4 50%	2 25%	8 8%
<b>Non-resident, employee</b>	1 100%					1 1%
<b>Non-resident, visitor</b>					1 100%	1 1%
<b>Resident outside of area</b>	1 50%				1 50%	2 2%
<b>Grand Total</b>	<b>12 12%</b>	<b>1 1%</b>	<b>2 2%</b>	<b>57 55%</b>	<b>32 31%</b>	<b>104 100%</b>

## Area 1 – Survey Results

### 13. In KURRABA ROAD between Alfred Street North & Clark Road,

I am in favour of replacing the existing 1 Hour Parking with (choose one):

Respondent Type	2 Hour Parking		4 Hour Parking		Other		Retain existing parking restrictions		No answer		Grand Total			
	Number	%	Number	%	Number	%	Number	%	Number	%	Number	%		
<b>Resident</b>														
Kurraba Road	1	25%						3	75%			4	4%	
Alfred Street North							1	14%	3	43%	3	43%	7	7%
Bray Street	2	33%	1	17%				3	50%			6	6%	
Clark Road	1	10%	1	10%				3	30%	5	50%	10	10%	
Darley Street	1	7%						7	50%	6	43%	14	13%	
Doris Street	1	11%	1	11%				7	78%			9	9%	
High Street								6	86%	1	14%	7	7%	
Margaret Street	1	11%	1	11%				1	11%	6	67%	9	9%	
Neutral Street	1	20%						3	60%	1	20%	5	5%	
Ormiston Avenue								1	100%			1	1%	
Whaling Road	2	11%	5	28%				5	28%	6	33%	18	17%	
	10	11%	9	10%	0		1	1%	42	47%	28	31%	90	87%
<b>Business owner</b>			2	100%								2	2%	
<b>Non-resident, owner</b>	2	25%	1	13%	1	13%			2	25%	2	25%	8	8%
<b>Non-resident, employee</b>			1	100%								1	1%	
<b>Non-resident, visitor</b>										1	100%	1	1%	
<b>Resident outside of area</b>	1	50%								1	50%	2	2%	
<b>Grand Total</b>	<b>13</b>	<b>13%</b>	<b>13</b>	<b>13%</b>	<b>1</b>	<b>1%</b>	<b>1</b>	<b>1%</b>	<b>44</b>	<b>42%</b>	<b>32</b>	<b>31%</b>	<b>104</b>	<b>100%</b>

### 14. In KURRABA ROAD near the corner of Clark Road opposite no. 66,

I am in favour of replacing the existing 1 Hour Parking with (choose one):

Respondent Type	2 Hour Parking		Other		Retain existing parking restrictions		No answer		Grand Total			
	Number	%	Number	%	Number	%	Number	%	Number	%		
<b>Resident</b>												
Kurraba Road							4	100%		4	4%	
Alfred Street North					1	14%	3	43%	3	43%	7	7%
Bray Street							6	100%		6	6%	
Clark Road							5	50%	5	50%	10	10%
Darley Street							9	64%	5	36%	14	13%
Doris Street							9	100%		9	9%	
High Street							6	86%	1	14%	7	7%
Margaret Street							3	33%	6	67%	9	9%
Neutral Street							4	80%	1	20%	5	5%
Ormiston Avenue							1	100%		1	1%	
Whaling Road	1	6%					10	56%	7	39%	18	17%
	1	1%	1	1%			60	67%	28	31%	90	87%
<b>Business owner</b>							2	100%		2	2%	
<b>Non-resident, owner</b>							6	75%	2	25%	8	8%
<b>Non-resident, employee</b>							1	100%		1	1%	
<b>Non-resident, visitor</b>								1	100%	1	1%	
<b>Resident outside of area</b>							1	50%	1	50%	2	2%
<b>Grand Total</b>	<b>1</b>	<b>1%</b>	<b>1</b>	<b>1%</b>	<b>70</b>	<b>67%</b>	<b>32</b>	<b>31%</b>	<b>104</b>	<b>100%</b>		

Area 1 – Survey Results

15. In LITTLE ALFRED STREET between Ormiston Avenue & Cul-de-sac,  
I am in favour of replacing the existing 1 Hour Parking with (choose one):

Respondent Type	2 Hour METER Parking		Other - 1/2 Hour Parking		Retain existing parking restrictions		No answer		Grand Total	
	Number	%	Number	%	Number	%	Number	%	Number	%
<b>Resident</b>										
Alfred Street North					4	57%	3	43%	7	7%
Bray Street					6	100%			6	6%
Clark Road					4	40%	6	60%	10	10%
Darley Street	1	7%			6	43%	7	50%	14	13%
Doris Street	1	11%			8	89%			9	9%
High Street					6	86%	1	14%	7	7%
Kurraba Road					3	75%	1	25%	4	4%
Margaret Street					2	22%	7	78%	9	9%
Neutral Street	1	20%			4	80%			5	5%
Ormiston Avenue			1	100%					1	1%
Whaling Road	3	17%			13	72%	2	11%	18	17%
	6	7%	1	1%	56	62%	27	30%	90	87%
<b>Business owner</b>	1	50%			1	50%			2	2%
<b>Non-resident, owner</b>	4	50%			2	25%	2	25%	8	8%
<b>Non-resident, employee</b>					1	100%			1	1%
<b>Non-resident, visitor</b>							1	100%	1	1%
<b>Resident outside of area</b>					1	50%	1	50%	2	2%
<b>Grand Total</b>	<b>11</b>	<b>11%</b>	<b>1</b>	<b>1%</b>	<b>61</b>	<b>59%</b>	<b>31</b>	<b>30%</b>	<b>104</b>	<b>100%</b>

Area 1 – Survey Results

16. In MARGARET STREET between Whaling Road & Clark Road,

I am in favour of replacing the existing 1 Hour Parking, 2 Hour Parking and some of the unrestricted parking with (choose one):

Respondent Type	1 Hour Parking		1 Hour METER Parking		2 Hour METER Parking		Other		Retain existing parking restrictions	No answer		Grand Total								
	Number	%	Number	%	Number	%	Number	%		Number	%	Number	%							
<b>Resident</b>																				
Margaret Street	4	44%						1	11%	2	22%	1	11%	1	11%	3	33%			
Alfred Street North												4	57%	3	43%	7	77%			
Bray Street	1	17%								3	30%	5	83%	6	66%	11	100%			
Clark Road	1	10%										4	40%	2	20%	6	60%			
Darley Street			1	7%								6	43%	7	50%	13	100%			
Doris Street	2	22%	1	11%					1	11%		5	56%	9	99%	11	100%			
High Street	1	14%			1	14%						4	57%	1	14%	5	57%			
Kurraba Road												3	75%	1	25%	4	100%			
Neutral Street	1	20%										4	80%	5	55%	10	100%			
Ormiston Avenue							1	100%						1	100%	1	100%			
Whaling Road	1	6%	1	6%	1	6%						13	72%	2	11%	15	87%			
	11	12%	3	3%	2	2%	1	1%	1	1%	5	6%	2	2%	49	54%	16	18%		
<b>Business owner</b>					1	50%						1	50%	2	2%	3	3%			
<b>Non-resident, owner</b>			2	25%	3	38%						1	13%	2	25%	5	62%			
<b>Non-resident, employee</b>												1	100%	1	1%	2	2%			
<b>Non-resident, visitor</b>														1	100%	1	1%			
<b>Resident outside of area</b>												1	50%	1	50%	2	2%			
<b>Grand Total</b>	<b>11</b>	<b>11%</b>	<b>5</b>	<b>5%</b>	<b>6</b>	<b>6%</b>	<b>1</b>	<b>1%</b>	<b>1</b>	<b>1%</b>	<b>5</b>	<b>5%</b>	<b>2</b>	<b>2%</b>	<b>53</b>	<b>51%</b>	<b>20</b>	<b>19%</b>	<b>104</b>	<b>100%</b>

## Area 1 – Survey Results

17. In NEUTRAL STREET between Ormiston Avenue & Whaling Road,  
I am in favour of replacing the existing 1/2 Hour Parking with (choose one):

Respondent Type	1/2 Hour METER Parking		1 Hour METER Parking		Other		Retain existing parking restrictions		No answer		Grand Total			
	Number	%	Number	%	Number	%	Number	%	Number	%	Number	%		
<b>Resident</b>														
Neutral Street							5	100%			5	5%		
Alfred Street North							4	57%	3	43%	7	7%		
Bray Street			1	17%			5	83%			6	6%		
Clark Road			1	10%	1	10%	3	30%	5	50%	10	10%		
Darley Street			1	7%			6	43%	7	50%	14	13%		
Doris Street	2	22%	1	11%	2	22%	4	44%			9	9%		
High Street							6	86%	1	14%	7	7%		
Kurraba Road			1	25%			1	25%	2	50%	4	4%		
Margaret Street	1	11%					1	11%	7	78%	9	9%		
Ormiston Avenue							1	100%			1	1%		
Whaling Road	1	6%	2	11%	1	6%	1	61%	2	11%	18	17%		
	4	4%	7	8%	4	4%	1	1%	47	52%	27	30%		
<b>Business owner</b>			1	50%					1	50%		2	2%	
<b>Non-resident, owner</b>			4	50%					3	38%	1	13%	8	8%
<b>Non-resident, employee</b>									1	100%		1	1%	
<b>Non-resident, visitor</b>										1	100%	1	1%	
<b>Resident outside of area</b>									1	50%	1	50%	2	2%
<b>Grand Total</b>	<b>4</b>	<b>4%</b>	<b>12</b>	<b>12%</b>	<b>4</b>	<b>4%</b>	<b>1</b>	<b>1%</b>	<b>53</b>	<b>51%</b>	<b>30</b>	<b>29%</b>	<b>104</b>	<b>100%</b>

18. In ORMISTON AVENUE between Little Alfred Street & Neutral Street,  
I am in favour of replacing the existing 1/2 Hour Parking with (choose one):

Respondent Type	1 Hour Parking		2 Hour Parking		Other		1 Hour METER Parking		Retain existing parking restrictions		No answer		Grand Total	
	Number	%	Number	%	Number	%	Number	%	Number	%	Number	%	Number	%
<b>Resident</b>														
Ormiston Avenue									1	100%			1	1%
Alfred Street North									4	57%	3	43%	7	7%
Bray Street	2	33%							4	67%			6	6%
Clark Road	2	20%							3	30%	5	50%	10	10%
Darley Street	1	7%							6	43%	7	50%	14	13%
Doris Street	2	22%							7	78%			9	9%
High Street	1	14%							5	71%	1	14%	7	7%
Kurraba Road	1	25%							2	50%	1	25%	4	4%
Margaret Street									2	22%	7	78%	9	9%
Neutral Street									5	100%			5	5%
Whaling Road	4	22%	1	6%	1	6%	1	6%	9	50%	3	17%	18	17%
	13	14%	1	1%	1	1%	1	1%	48	53%	27	30%	90	87%
<b>Business owner</b>	1	50%							1	50%			2	2%
<b>Non-resident, owner</b>	3	38%							4	50%	1	13%	8	8%
<b>Non-resident, employee</b>	1	100%											1	1%
<b>Non-resident, visitor</b>											1	100%	1	1%
<b>Resident outside of area</b>	1	50%									1	50%	2	2%
<b>Grand Total</b>	<b>19</b>	<b>18%</b>	<b>1</b>	<b>1%</b>	<b>1</b>	<b>1%</b>	<b>1</b>	<b>1%</b>	<b>53</b>	<b>51%</b>	<b>30</b>	<b>29%</b>	<b>104</b>	<b>100%</b>

Area 1 – Survey Results

19. In RAWSON STREET between Darley Road & Kurraba Road,  
I am in favour of replacing the existing 2 Hour Parking with (choose one):

Respondent Type	Other						Grand Total			
	1 Hour Parking		1 Hour Residents Only Parking		2 Hour METER Parking			Retain existing parking restrictions	No answer	
	Number	%	Number	%	Number	%	Number	%	Number	%
<b>Resident</b>										
Alfred Street North					4	57%	3	43%	7	7%
Bray Street					6	100%			6	6%
Clark Road					5	50%	5	50%	10	10%
Darley Street			1	7%	1	7%	8	57%	4	29%
Doris Street					8	89%	1	11%	9	9%
High Street					6	86%	1	14%	7	7%
Kurraba Road	1	25%			2	50%	1	25%	4	4%
Margaret Street					1	11%	8	89%	9	9%
Neutral Street					4	80%	1	20%	5	5%
Ormiston Avenue					1	100%			1	1%
Whaling Road					12	67%	6	33%	18	17%
	1	1%	1	1%	1	1%	57	63%	30	33%
<b>Business owner</b>					2	100%			2	2%
<b>Non-resident, owner</b>					6	75%	2	25%	8	8%
<b>Non-resident, employee</b>					1	100%			1	1%
<b>Non-resident, visitor</b>							1	100%	1	1%
<b>Resident outside of area</b>					1	50%	1	50%	2	2%
<b>Grand Total</b>	<b>1</b>	<b>1%</b>	<b>1</b>	<b>1%</b>	<b>1</b>	<b>1%</b>	<b>67</b>	<b>64%</b>	<b>34</b>	<b>33%</b>
									<b>104</b>	<b>100%</b>

Area 1 – Survey Results

20. In WHALING ROAD between Little Alfred Street & Cul-de-sac,

I am in favour of replacing the existing 1/2 Hour Parking and some of the unrestricted parking with (choose one):

Respondent Type	1 Hour METER Parking		2 Hour METER Parking		Other				Retain existing parking restrictions		No answer		Grand Total			
	Number	%	Number	%	Number	%	Number	%	Number	%	Number	%	Number	%		
<b>Resident</b>																
Whaling Road	1	6%	3	17%	1	6%					13	72%		18	17%	
Alfred Street North										4	57%	3	43%	7	7%	
Bray Street										6	100%			6	6%	
Clark Road	1	10%			1	10%				3	30%	5	50%	10	10%	
Darley Street	1	7%	1	7%						5	36%	7	50%	14	13%	
Doris Street	1	11%						1	11%	1	11%			6	67%	
High Street	1	14%	1	14%						6	67%	1	14%	9	9%	
Kurraba Road										4	57%			7	7%	
Margaret Street										3	75%	1	25%	4	4%	
Neutral Street					1	11%				4	44%	4	44%	9	9%	
Ormiston Avenue							1	100%		5	100%			5	5%	
	5	6%	5	6%	3	3%	1	1%	1	1%	1	1%	53	59%	21	23%
<b>Business owner</b>			1	50%							1	50%			2	2%
<b>Non-resident, owner</b>	2	25%	2	25%							3	38%	1	13%	8	8%
<b>Non-resident, employee</b>											1	100%			1	1%
<b>Non-resident, visitor</b>												1	100%	1	1%	
<b>Resident outside of area</b>											1	50%	1	50%	2	2%
<b>Grand Total</b>	<b>7</b>	<b>7%</b>	<b>8</b>	<b>8%</b>	<b>3</b>	<b>3%</b>	<b>1</b>	<b>1%</b>	<b>1</b>	<b>1%</b>	<b>1</b>	<b>1%</b>	<b>59</b>	<b>57%</b>	<b>24</b>	<b>23%</b>



Area 1 – Survey Results

21. In WHALING ROAD between Alfred Street North & Little Alfred Street,  
I am in favour of replacing the existing 2 Hour METER Parking with (choose one):

Respondent Type	1 Hour METER Parking		Other		1 Hour Parking		Other - see comments		Retain existing parking restrictions		No answer		Grand Total	
	Number	%	Number	%	Number	%	Number	%	Number	%	Number	%	Number	%
<b>Resident</b>														
Whaling Road	2	11%	1	6%					14	78%	1	6%	18	17%
Alfred Street North									4	57%	3	43%	7	7%
Bray Street					1	17%			5	83%			6	6%
Clark Road	2	20%							3	30%	5	50%	10	10%
Darley Street									7	50%	7	50%	14	13%
Doris Street	2	22%							6	67%	1	11%	9	9%
High Street	1	14%							5	71%	1	14%	7	7%
Kurraba Road									2	50%	2	50%	4	4%
Margaret Street	1	11%							4	44%	4	44%	9	9%
Neutral Street	2	40%							3	60%			5	5%
Ormiston Avenue									1	100%			1	1%
	10	11%	1	1%	1	1%			54	60%	24	27%	90	87%
<b>Business owner</b>									2	100%			2	2%
<b>Non-resident, owner</b>	1	13%							6	75%	1	13%	8	8%
<b>Non-resident, employee</b>									1	100%			1	1%
<b>Non-resident, visitor</b>											1	100%	1	1%
<b>Resident outside of area</b>									1	50%	1	50%	2	2%
<b>Grand Total</b>	<b>11</b>	<b>11%</b>	<b>1</b>	<b>1%</b>	<b>1</b>	<b>1%</b>			<b>64</b>	<b>62%</b>	<b>27</b>	<b>26%</b>	<b>104</b>	<b>100%</b>

Area 1 – Survey Results

22. The current parking restrictions usually expire at 6.00pm.  
I would like them to be extended to (choose one):

Respondent Type	8pm		10pm		Midnight		No answer		Grand Total	
	Number	%	Number	%	Number	%	Number	%	Number	%
<b>Resident</b>										
Alfred Street North	2	29%					5	71%	7	7%
Bray Street	2	33%					4	67%	6	6%
Clark Road	2	20%					8	80%	10	10%
Darley Street	6	43%	1	7%			7	50%	14	13%
Doris Street	2	22%			2	22%	5	56%	9	9%
High Street	4	57%			1	14%	2	29%	7	7%
Kurraba Road	1	25%					3	75%	4	4%
Margaret Street	3	33%					6	67%	9	9%
Neutral Street	2	40%					3	60%	5	5%
Ormiston Avenue	1	100%							1	1%
Whaling Road	5	28%	1	6%			12	67%	18	17%
	30	33%	2	2%	3	3%	55	61%	90	87%
<b>Business owner</b>	1	50%					1	50%	2	2%
<b>Non-resident, owner</b>	5	63%					3	38%	8	8%
<b>Non-resident, employee</b>							1	100%	1	1%
<b>Non-resident, visitor</b>							1	100%	1	1%
<b>Resident outside of area</b>	2	100%							2	2%
<b>Grand Total</b>	<b>38</b>	<b>37%</b>	<b>2</b>	<b>2%</b>	<b>3</b>	<b>3%</b>	<b>61</b>	<b>59%</b>	<b>104</b>	<b>100%</b>

23. I would like the parking restrictions to operate (choose one):

Respondent Type	Monday to Friday only		Monday to Saturday		Monday to Sunday		No answer		Grand Total	
	Number	%	Number	%	Number	%	Number	%	Number	%
<b>Resident</b>										
Alfred Street North	5	71%					2	29%	7	7%
Bray Street	6	100%							6	6%
Clark Road	6	60%			1	10%	3	30%	10	10%
Darley Street	9	64%	1	7%	1	7%	3	21%	14	13%
Doris Street	6	67%			2	22%	1	11%	9	9%
High Street	5	71%	1	14%	1	14%			7	7%
Kurraba Road	3	75%	1	25%					4	4%
Margaret Street	2	22%	1	11%	1	11%	5	56%	9	9%
Neutral Street	3	60%	1	20%	1	20%			5	5%
Ormiston Avenue	1	100%							1	1%
Whaling Road	15	83%	1	6%	2	11%			18	17%
	61	68%	6	7%	9	10%	14	16%	90	87%
<b>Business owner</b>	2	100%							2	2%
<b>Non-resident, owner</b>	6	75%			1	13%	1	13%	8	8%
<b>Non-resident, employee</b>	1	100%							1	1%
<b>Non-resident, visitor</b>							1	100%	1	1%
<b>Resident outside of area</b>	2	100%							2	2%
<b>Grand Total</b>	<b>72</b>	<b>69%</b>	<b>6</b>	<b>6%</b>	<b>10</b>	<b>10%</b>	<b>16</b>	<b>15%</b>	<b>104</b>	<b>100%</b>

Area 1 - Summary of Survey Results and Proposed Changes

Zone ID	Street	Street No.	Weekday Average Occupancy	No. Bays	Current Restrictions	Proposed Restrictions	Comments
<b>Alfred Street North</b>			<b>73%</b>				
968	Alfred Street North	343	50%	4	1 Hour Parking 8.30am - 6pm Mon - Fri Permit Holders Excepted Area 1	<b>Retain</b>	Overall 42% of respondents do not support changes to existing parking. Alfred Street North residents - 71% retain existing and 29% support changes. Overall residents - 43% retain existing.
969	Alfred Street North	339	86%	7	Unrestricted Parking	<b>Retain</b>	Overall 42% of respondents do not support changes to existing parking. Alfred Street North residents - 71% retain existing and 29% support changes. Overall residents - 43% retain existing.
972	Alfred Street North	323	64%	14	1 Hour Meter Parking 8.30am - 6pm Mon - Fri Permit Holders Excepted Area 1	<b>Retain</b>	Overall 63% of respondents do not support changes to existing parking. Alfred Street North residents - 86% retain existing and 14% support changes. Overall residents - 64% retain existing.
973	Alfred Street North	317	63%	16	1 Hour Meter Parking 8.30am - 6pm Mon - Fri Permit Holders Excepted Area 1	<b>Retain</b>	Overall 48% of respondents do not support changes to existing parking. Alfred Street North residents - 71% retain existing and 29% support changes. Overall residents - 50% retain existing.
975	Alfred Street North	271	60%	5	1 Hour Meter Parking 8.30am - 6pm Mon - Fri	<b>Retain</b>	Overall 48% of respondents do not support changes to existing parking. Alfred Street North residents - 71% retain existing and 29% support changes. Overall residents - 50% retain existing.
976	Alfred Street North	1A	64%	7	2 Hour Meter Parking 8.30am - 6pm Mon - Fri	<b>Retain</b>	Overall 48% of respondents do not support changes to existing parking. Alfred Street North residents - 71% retain existing and 29% support changes. Overall residents - 50% retain existing.
979	Alfred Street North	317	50%	48	9 Hour Meter Parking 9am - 6pm Mon - Fri Permit Holders Excepted Area 1	<b>Retain</b>	Overall 61% of respondents do not support changes to existing parking. Alfred Street North residents - 71% retain existing and 29% support changes. Overall residents - 59% retain existing.
980	Alfred Street North	341	97%	15	Unrestricted Parking	<b>Retain</b>	Overall 42% of respondents do not support changes to existing parking. Alfred Street North residents - 71% retain existing and 29% support changes. Overall residents - 43% retain existing.
1147	Alfred Street North	357	75%	6	2 Hour Parking 8.30am - 6pm Mon - Fri Permit Holders Excepted Area 1	<b>Retain</b>	Overall 42% of respondents do not support changes to existing parking. Alfred Street North residents - 71% retain existing and 29% support changes. Overall residents - 43% retain existing.
1147A	Alfred Street North	357	100%	3	Unrestricted Parking	<b>Retain</b>	Overall 42% of respondents do not support changes to existing parking. Alfred Street North residents - 71% retain existing and 29% support changes. Overall residents - 43% retain existing.
1147B	Alfred Street North	369	100%	3	Unrestricted Parking	<b>Retain</b>	Overall 42% of respondents do not support changes to existing parking. Alfred Street North residents - 71% retain existing and 29% support changes. Overall residents - 43% retain existing.
<b>Bray Street</b>			<b>33%</b>				
1021	Bray Street	19	33%	1	1/2 Hour Parking 8.30am - 6pm Mon - Fri Permit Holders Excepted Area 1	<b>2 Hour Parking 8.30am - 6pm Mon - Fri Permit Holders Excepted Area 1</b>	Overall 40% of respondents do not support changes to existing parking. Bray Street residents - 50% retain existing and 50% support changes. 33% support an increase to 2 Hour Parking.

Area 1 - Summary of Survey Results and Proposed Changes

Zone ID	Street	Street No.	Weekday Average Occupancy	No. Bays	Current Restrictions	Proposed Restrictions	Comments
Clark Road			73%				
988	Clark Road	64	88%	4	1/2 Hour Parking 8.30am - 6pm Mon - Fri 8.30am - 12.30pm Sat	Retain	Overall 53% of respondents do not support changes to existing parking. Clark Road residents - 30% retain existing and 30% support changes. Overall residents - 54% retain existing.
989	Clark Road	64	50%	4	1/2 Hour Parking 8.30am - 6pm Mon - Fri 8.30am - 12.30pm Sat	Retain	Overall 53% of respondents do not support changes to existing parking. Clark Road residents - 30% retain existing and 30% support changes. Overall residents - 54% retain existing.
990	Clark Road	64	63%	4	1/4 Hour Parking 8am - 8pm Mon - Sun	Retain	Overall 53% of respondents do not support changes to existing parking. Clark Road residents - 30% retain existing and 30% support changes. Overall residents - 54% retain existing.
991	Clark Road	62	100%	2	2 Hour Parking 8.30am - 6pm Mon - Fri Permit Holders Excepted Area 1	<b>Update opening sign to match closing sign: 2 Hour Parking 8.30am - 6pm Mon - Fri Permit Holders Excepted Area 1</b>	Overall 61% of respondents do not support changes to existing parking. Clark Road residents - 70% retain existing and 0% support changes. Overall residents - 59% retain existing. Note: the opening sign at this location indicates "2 Hour Parking 8.30am - 6pm Mon - Fri Permit Holders with <b>Mobility Permit</b> Excepted Area 1". Origin of sign unconfirmed, therefore recommending the removal of "Mobility Permit" to match existing closing sign.
992	Clark Road	60	60%	5	2 Hour Parking 8.30am - 6pm Mon - Fri Permit Holders Excepted Area 1	Retain	Overall 61% of respondents do not support changes to existing parking. Clark Road residents - 70% retain existing and 0% support changes. Overall residents - 59% retain existing.
993	Clark Road	54	96%	28	Unrestricted Parking	Retain	Overall 61% of respondents do not support changes to existing parking. Clark Road residents - 70% retain existing and 0% support changes. Overall residents - 59% retain existing.
993A	Clark Road	38	55%	10	2 Hour Parking 8.30am - 6pm Mon - Fri Permit Holders Excepted Area 1	Retain	Overall 61% of respondents do not support changes to existing parking. Clark Road residents - 70% retain existing and 0% support changes. Overall residents - 59% retain existing.

Area 1 - Summary of Survey Results and Proposed Changes

Zone ID	Street	Street No.	Weekday Average Occupancy	No. Bays	Current Restrictions	Proposed Restrictions	Comments
<b>Darley Street</b>			<b>56%</b>				
965	Darley Street	37	72%	9	4 Hour Parking 8.30am - 6pm Mon - Fri Permit Holders Excepted Area 1	<b>Retain</b>	Overall 47% of respondents do not support changes to existing parking. Darley Street residents - 29% retain existing and 49% support changes. Overall residents - 49% retain existing. Changes suggested by respondents will result in no net change in the number of 1 Hour and 4 Hour parking spaces, therefore recommendation is to retain existing restrictions.
966	Darley Street	5	45%	11	1 Hour Parking 8.30am - 6pm Mon - Fri Permit Holders Excepted Area 1	<b>Retain</b>	Overall 47% of respondents do not support changes to existing parking. Darley Street residents - 29% retain existing and 49% support changes. Overall residents - 49% retain existing. Changes suggested by respondents will result in no net change in the number of 1 Hour and 4 Hour parking spaces, therefore recommendation is to retain existing restrictions.
967	Darley Street	5	100%	3	Unrestricted Parking	<b>Retain</b>	Overall 47% of respondents do not support changes to existing parking. Darley Street residents - 29% retain existing and 49% support changes. Overall residents - 49% retain existing. Changes suggested by respondents will result in no net change in the number of 1 Hour and 4 Hour parking spaces, therefore recommendation is to retain existing restrictions.
1144	Darley Street	30	47%	15	1 Hour Parking 8.30am - 6pm Mon - Fri Permit Holders Excepted Area 1	<b>Retain</b>	Overall 47% of respondents do not support changes to existing parking. Darley Street residents - 29% retain existing and 49% support changes. Overall residents - 49% retain existing. Changes suggested by respondents will result in no net change in the number of 1 Hour and 4 Hour parking spaces, therefore recommendation is to retain existing restrictions.
1145	Darley Street	6	45%	10	1 Hour Parking 8.30am - 6pm Mon - Fri Permit Holders Excepted Area 1	<b>Retain</b>	Overall 47% of respondents do not support changes to existing parking. Darley Street residents - 29% retain existing and 49% support changes. Overall residents - 49% retain existing. Changes suggested by respondents will result in no net change in the number of 1 Hour and 4 Hour parking spaces, therefore recommendation is to retain existing restrictions.
965A	Darley Street	7	25%	2	1 Hour Parking 8.30am - 6pm Mon - Fri Permit Holders Excepted Area 1	<b>Retain</b>	Overall 47% of respondents do not support changes to existing parking. Darley Street residents - 29% retain existing and 49% support changes. Overall residents - 49% retain existing. Changes suggested by respondents will result in no net change in the number of 1 Hour and 4 Hour parking spaces, therefore recommendation is to retain existing restrictions.
<b>Doris Street</b>			<b>71%</b>				
1007	Doris Street	2A	50%	3	Unrestricted Parking	<b>Retain</b>	Overall 57% of respondents do not support changes to existing parking. Doris Street residents - 44% retain existing and 33% support changes. Overall residents - 56% retain existing. Based on recent occupancy rates, it is recommended that the existing restrictions are retained.
1008	Doris Street	2A	58%	12	1 Hour Parking 8.30am - 6pm Mon - Fri Permit Holders Excepted Area 1	<b>Retain</b>	Overall 57% of respondents do not support changes to existing parking. Doris Street residents - 44% retain existing and 33% support changes. Overall residents - 56% retain existing. Based on recent occupancy rates, it is recommended that the existing restrictions are retained.
1009	Doris Street	3	100%	2	Unrestricted Parking	<b>Retain</b>	Overall 57% of respondents do not support changes to existing parking. Doris Street residents - 44% retain existing and 33% support changes. Overall residents - 56% retain existing. Based on recent occupancy rates, it is recommended that the existing restrictions are retained.
1010	Doris Street	9	77%	15	1 Hour Parking 8.30am - 6pm Mon - Fri Permit Holders Excepted Area 1	<b>Retain</b>	Overall 57% of respondents do not support changes to existing parking. Doris Street residents - 44% retain existing and 33% support changes. Overall residents - 56% retain existing. Based on recent occupancy rates, it is recommended that the existing restrictions are retained.

Area 1 - Summary of Survey Results and Proposed Changes

Zone ID	Street	Street No.	Weekday Average Occupancy	No. Bays	Current Restrictions	Proposed Restrictions	Comments
<b>High Street</b>			<b>65%</b>				
977	High Street	30	65%	10	2 Hour Parking 8.30am - 6pm Mon - Fri Permit Holders Excepted	<b>Retain</b>	Overall 55% of respondents do not support changes to existing parking. High Street residents - 71% retain existing and 14% support changes. Overall residents - 59% retain existing.
<b>Kurraba Road</b>			<b>48%</b>				
981	Kurraba Road	12	63%	4	1 Hour Parking 8.30am - 6pm Mon - Fri Permit Holders Excepted Area 1	<b>Retain</b>	Overall 42% of respondents do not support changes to existing parking. Kurraba Road residents - 75% retain existing and 25% support changes. Overall residents - 47% retain existing.
982	Kurraba Road	28	75%	2	1 Hour Parking 8.30am - 6pm Mon - Fri 8.30am - 12.30pm Sat Permit Holders Excepted Area 1	<b>Retain</b>	Overall 42% of respondents do not support changes to existing parking. Kurraba Road residents - 75% retain existing and 25% support changes. Overall residents - 47% retain existing.
983	Kurraba Road	32	54%	12	1 Hour Parking 8.30am - 6pm Mon - Fri Permit Holders Excepted Area 1	<b>Retain</b>	Overall 42% of respondents do not support changes to existing parking. Kurraba Road residents - 75% retain existing and 25% support changes. Overall residents - 47% retain existing.
984	Kurraba Road	40	0%	1	1 Hour Parking 8.30am - 6pm Mon - Fri 8.30am - 12.30pm Sat	<b>Retain</b>	Overall 67% of respondents do not support changes to existing parking. Kurraba Road residents - 100% retain existing and 0% support changes. Overall residents - 67% retain existing.
<b>Little Alfred Street</b>			<b>70%</b>				
1011	Little Alfred Street	4	50%	6	1 Hour Parking 8.30am - 6pm Mon - Fri Permit Holders Excepted Area 1	<b>Retain</b>	Overall 59% of respondents do not support changes to existing parking. Little Alfred Street residents - 57% retain existing and 0% support changes. Overall residents - 62% retain existing.
1013	Little Alfred Street	4	50%	4	1 Hour Parking 8.30am - 6pm Mon - Fri Permit Holders Excepted Area 1	<b>Retain</b>	Overall 59% of respondents do not support changes to existing parking. Little Alfred Street residents - 57% retain existing and 0% support changes. Overall residents - 62% retain existing.
1014	Little Alfred Street	4	100%	1	1 Hour Parking 8.30am - 6pm Mon - Fri Permit Holders Excepted Area 1	<b>Retain</b>	Overall 59% of respondents do not support changes to existing parking. Little Alfred Street residents - 57% retain existing and 0% support changes. Overall residents - 62% retain existing.
1015	Little Alfred Street	5	80%	5	1 Hour Parking 8.30am - 6pm Mon - Fri Permit Holders Excepted Area 1	<b>Retain</b>	Overall 59% of respondents do not support changes to existing parking. Little Alfred Street residents - 57% retain existing and 0% support changes. Overall residents - 62% retain existing.

Area 1 - Summary of Survey Results and Proposed Changes

Zone ID	Street	Street No.	Weekday Average Occupancy	No. Bays	Current Restrictions	Proposed Restrictions	Comments
<b>Margaret Street</b>			<b>92%</b>				
995	Margaret Street	28	92%	6	1 Hour Parking 8.30am - 10pm Mon - Sun Permit Holders Excepted Area 1	<b>Retain</b>	Overall 51% of respondents do not support changes to existing parking. Margaret Street residents - 11% retain existing and 88% support changes. Residents in this street generally support changes with 18 residents signing a petition to change the 2 Hour Parking to 1/2 Hour Parking and unrestricted parking to 4 Hour Parking.
996	Margaret Street	1	75%	6	2 Hour Parking 8.30am - 6pm Mon - Fri Permit Holders Excepted Area 1	<b>1/2 Hour Parking 8.30am - 6pm Mon - Fri Permit Holders Excepted Area 1</b>	Overall 51% of respondents do not support changes to existing parking. Margaret Street residents - 11% retain existing and 88% support changes. Residents in this street generally support changes with 18 residents signing a petition to change the 2 Hour Parking to 1/2 Hour Parking and unrestricted parking to 4 Hour Parking.
997	Margaret Street	4	100%	3	Unrestricted Parking	<b>4 Hour Parking 8.30am - 6pm Mon - Fri Permit Holders Excepted Area 1</b>	Overall 51% of respondents do not support changes to existing parking. Margaret Street residents - 11% retain existing and 88% support changes. Residents in this street generally support changes with 18 residents signing a petition to change the 2 Hour Parking to 1/2 Hour Parking and unrestricted parking to 4 Hour Parking.
995A	Margaret Street	8	100%	2	1 Hour Parking 8.30am - 10pm Mon - Sun Permit Holders Excepted Area 1	<b>Retain</b>	Overall 51% of respondents do not support changes to existing parking. Margaret Street residents - 11% retain existing and 88% support changes. Residents in this street generally support changes with 18 residents signing a petition to change the 2 Hour Parking to 1/2 Hour Parking and unrestricted parking to 4 Hour Parking.
<b>Neutral Street</b>			<b>67%</b>				
1017	Neutral Street	25	61%	9	1/2 Hour Parking 8.30am - 6pm Mon - Fri Permit Holders Excepted Area 1	<b>Retain</b>	Overall 51% of respondents do not support changes to existing parking. Neutral Street residents - 100% retain existing and 0% support changes. Overall residents - 52% retain existing.
1018	Neutral Street	7	50%	8	1/2 Hour Parking 8.30am - 6pm Mon - Fri Permit Holders Excepted Area 1	<b>Retain</b>	Overall 51% of respondents do not support changes to existing parking. Neutral Street residents - 100% retain existing and 0% support changes. Overall residents - 52% retain existing.
1019	Neutral Street	4	62%	17	1/2 Hour Parking 8.30am - 6pm Mon - Fri Permit Holders Excepted Area 1	<b>Retain</b>	Overall 51% of respondents do not support changes to existing parking. Neutral Street residents - 100% retain existing and 0% support changes. Overall residents - 52% retain existing.
1020	Neutral Street	26	86%	7	1/2 Hour Parking 8.30am - 6pm Mon - Fri Permit Holders Excepted Area 1	<b>Retain</b>	Not included in the survey
1022	Neutral Street	57	75%	4	1/2 Hour Parking 8.30am - 6pm Mon - Fri Permit Holders Excepted Area 1	<b>Retain</b>	Not included in the survey
<b>Ormiston Avenue</b>			<b>38%</b>				
1016	Ormiston Avenue	4	38%	4	1/2 Hour Parking 8.30am - 6pm Mon - Fri Permit Holders Excepted Area 1	<b>Retain</b>	Overall 51% of respondents do not support changes to existing parking. Ormiston Avenue residents - 100% retain existing and 0% support changes. Overall residents - 53% retain existing.

Area 1 - Summary of Survey Results and Proposed Changes

Zone ID	Street	Street No.	Weekday Average Occupancy	No. Bays	Current Restrictions	Proposed Restrictions	Comments
<b>Rawson Street</b>			<b>26%</b>				
985	Rawson Street	49	26%	19	2 Hour Parking 8.30am - 6pm Mon - Fri Permit Holders Excepted Area 1	<b>Retain</b>	Overall 64% of respondents do not support changes to existing parking. Rawson Street residents - 57% retain existing and 0% support changes. Overall residents - 63% retain existing.
<b>Whaling Road</b>			<b>82%</b>				
998	Whaling Road	30	83%	3	1/2 Hour Parking 8.30am - 6pm Mon - Fri Permit Holders Excepted Area 1	<b>Retain</b>	Overall 57% of respondents do not support changes to existing parking. Whaling Road residents - 72% retain existing and 29% support changes. Overall residents - 59% retain existing.
999	Whaling Road	36	100%	3	Unrestricted Parking	<b>Retain</b>	Overall 57% of respondents do not support changes to existing parking. Whaling Road residents - 72% retain existing and 29% support changes. Overall residents - 59% retain existing.
1000	Whaling Road	53	100%	6	1/2 Hour Parking 8.30am - 6pm Mon - Fri Permit Holders Excepted Area 1	<b>Retain</b>	Overall 57% of respondents do not support changes to existing parking. Whaling Road residents - 72% retain existing and 29% support changes. Overall residents - 59% retain existing.
1001	Whaling Road	41	81%	8	Unrestricted Parking	<b>Retain</b>	Overall 57% of respondents do not support changes to existing parking. Whaling Road residents - 72% retain existing and 29% support changes. Overall residents - 59% retain existing.
1002	Whaling Road	21	63%	8	1/2 Hour Parking 8.30am - 6pm Mon - Fri Permit Holders Excepted Area 1	<b>Retain</b>	Overall 57% of respondents do not support changes to existing parking. Whaling Road residents - 72% retain existing and 29% support changes. Overall residents - 59% retain existing.
1003	Whaling Road	1A	50%	4	2 Hour Meter Parking 8.30am - 6pm Mon - Fri	<b>Retain</b>	Overall 62% of respondents do not support changes to existing parking. Whaling Road residents - 78% retain existing and 17% support changes. Overall residents - 60% retain existing.
1004	Whaling Road	2	100%	5	2 Hour Meter Parking 8.30am - 6pm Mon - Fri	<b>Retain</b>	Overall 62% of respondents do not support changes to existing parking. Whaling Road residents - 78% retain existing and 17% support changes. Overall residents - 60% retain existing.
1005	Whaling Road	4	63%	4	1/2 Hour Parking 8.30am - 6pm Mon - Fri Permit Holders Excepted Area 1	<b>Retain</b>	Overall 57% of respondents do not support changes to existing parking. Whaling Road residents - 72% retain existing and 29% support changes. Overall residents - 59% retain existing.
1006	Whaling Road	20	100%	3	1/2 Hour Parking 8.30am - 6pm Mon - Fri Permit Holders Excepted Area 1	<b>Retain</b>	Overall 57% of respondents do not support changes to existing parking. Whaling Road residents - 72% retain existing and 29% support changes. Overall residents - 59% retain existing.

Results - Parking Restrictions expire and operate

Area 1 - Various Streets	<p>Overall 59% of respondents did not support an extension to the 6pm expiry time. Overall 67% residents did not support an extension to the 6pm expiry time. Fifteen (15) comments were received requesting for the 6pm expiry time to be retained.</p> <p>Overall 69% of respondents support Monday to Friday operation. Overall 68% residents support Monday to Friday operation.</p>
--------------------------	--



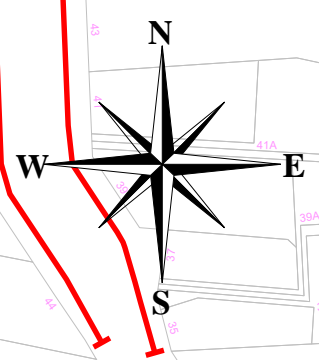
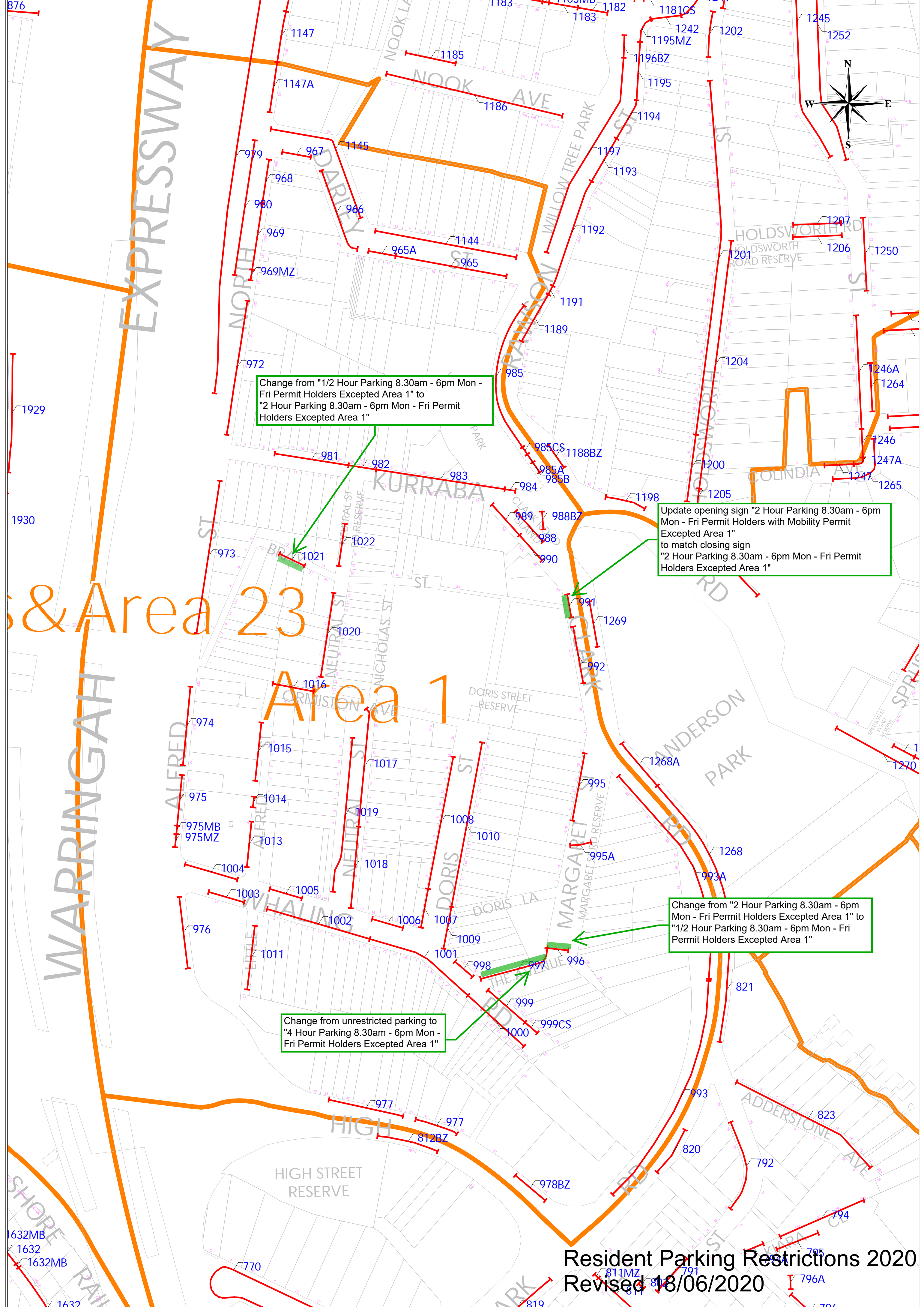

Change from "1/2 Hour Parking 8.30am - 6pm Mon - Fri Permit Holders Excepted Area 1" to "2 Hour Parking 8.30am - 6pm Mon - Fri Permit Holders Excepted Area 1"

Update opening sign "2 Hour Parking 8.30am - 6pm Mon - Fri Permit Holders with Mobility Permit Excepted Area 1" to match closing sign "2 Hour Parking 8.30am - 6pm Mon - Fri Permit Holders Excepted Area 1"

Change from "2 Hour Parking 8.30am - 6pm Mon - Fri Permit Holders Excepted Area 1" to "1/2 Hour Parking 8.30am - 6pm Mon - Fri Permit Holders Excepted Area 1"

Change from unrestricted parking to "4 Hour Parking 8.30am - 6pm Mon - Fri Permit Holders Excepted Area 1"

Warringah & Area 23

Area 1

Resident Parking Restrictions 2020  
Revised 18/06/2020