

PLANTS SCHEDULE

Common Name	Mature Height	Pot Size	Qty	
<i>Alocasia brisbanensis</i>	Colocasia	2m	300mm	22
<i>Banksia serrata</i>	Old Man Banksia	3-6m	200Ltr	6
<i>Callistemon linearifolius</i>	Netted bottlebrush	3-4m	400mm	14
<i>Cissus antarctica</i>	Kangaroo Vine	0.3m	200mm	424
<i>Cordyline australis</i>	Cabbage-palm	1.5m	200mm	3
<i>Cyathea australis</i>	Rough tree fern	3-7m	100Ltr	6
<i>Doranthus excelsa</i>	Gymea Lily	1-3m	400mm	11
<i>Ficus pumila</i>	Creeping Fig	200mm	climber	10
<i>Hibbertia scandens</i>	Guinea Flower	Climber	200mm	142
<i>Leptospermum laevigatum</i>	Coastal Tea Tree	2-5m	400mm	14
<i>Lomandra sp.</i>	Spiny Headed Matt Grass	1.2m	200mm	493
<i>Macrozamia communis</i>	Burrawang	1.5-2m	400mm	6
<i>Pandorea pandorana</i>	Wonga Wonga Vine	Climber	200mm	103
<i>Pennisetum 'Nafray'</i>	Dwarf Fountain Grass	0.6m	200mm	113
<i>Viola hederacea</i>	Native Violet	0.2m	140mm	432
<i>Westringia fruticosa</i>	Coastal Rosemary	2m	300mm	15

Denotes Native Species

GENERAL NOTES

**Graphic Illustration**

Please note that the plant graphics are indicative sizes only and not an accurate representation at time of purchase. Do not scale from drawings. All dimensions in mm unless otherwise stated. Figure dimensions shall take precedence over scale. Contractors must verify all dimensions on site before commencing any work or making shop drawings. All works shall be carried out in accordance with ASABCA and Local Government Regulations. This drawing is protected by copyright.

**Site Preparation**

All existing plants marked for retention shall be protected for the duration of works. Remove from site all perennial weeds and rubbish before commencing landscape works.

**Soilworks**

Thoroughly cultivate the subsoil to a depth of 200mm. Supply and install to a depth of 300mm quality garden soil mix to all planting beds and 150mm turf underlay to lawn areas.

**Mulch**

Supply and install a 75mm layer of hardwood horticultural grade mulch to all planting beds set down 25mm from adjacent paving or garden edge.

**Maintenance**

All failed or defective plant species to be replaced by landscaper for a 3 months period following completion of work. Further maintenance during and after this period should include watering, weeding, fertilising, pest and disease control, pruning and hedging, reinstatement of mulch and keeping the site neat and tidy.

GENERAL PLANTING NOTES

**Note** It is recommended that all plants used be subject to an establishment period. During this period maintenance work carried out will include, watering, mowing, weeding, fertilising, pest and disease control, reseeding, returfing, staking and tying, replanting, cultivating, pruning, hedge clipping, aerating, reinstatement of mulch, top dressing and keeping the site neat and tidy.

**Note** Plants shall be vigorous, well established, of good form consistent with species or variety, not soft or forced, free from disease and insect pests, with large healthy root systems and no evidence of having been restricted in growth or damaged. Root system shall be well balanced in relation to the size of the plant.

**Note** install "root barrier" or equivalent to manufacturers specifications to protect nearby structures and services.

**Note** install temporary drip irrigation system under mulch in tree protection zones and water on allotted days.

LOCATION MAP

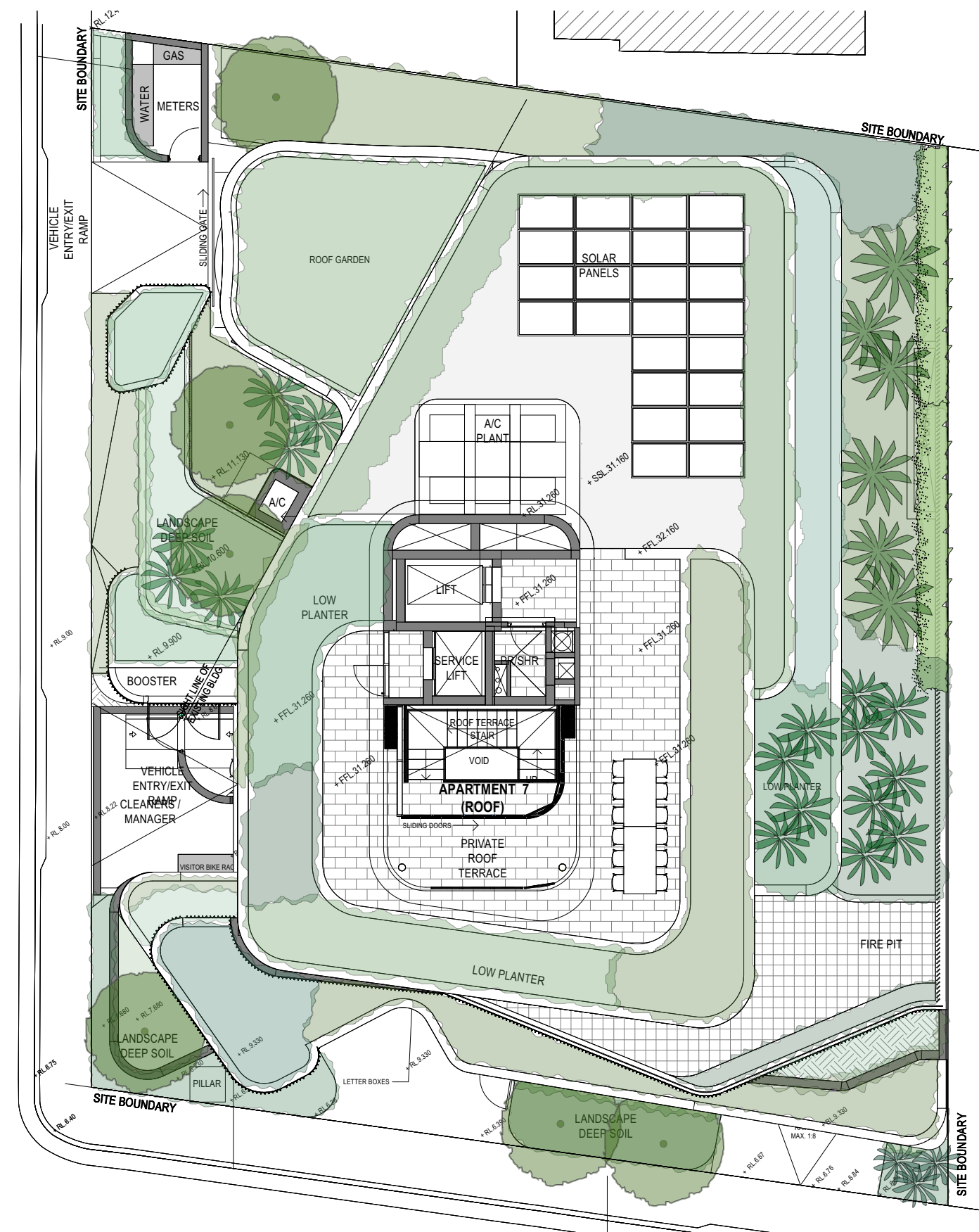





19/200mm Pennisetum nafray  
w/ 8/140mm Hibbertia scandens in front

56/140mm Hibbertia scandens

72/200mm Pandorea pandorana

Figure dimensions shall take precedence over scale. Contractors must verify all dimensions on job before commencing any work or making shop drawings. This drawing is protected by copyright.

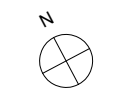

Client: Stable Properties

Project Address:  
22 Waruda Street  
Kirribilli NSW 2061

Dwg no:  
LP03-04422  
Title: DA  
Upper Ground Landscape Plan

Drawn by:  
TB  
Issue: 01  
Checked:  
WD  
Revision:  
L  
Scale:  
1:100 @ A2  
Date:  
29.08.2023

Dangar Barin Smith  
Landscape Design Sydney  
53 Cranbrook St, Botany

T (02) 9316 9044  
F (02) 9316 9055



Level 1 Landscape Plan

Figure dimensions shall take precedence over scale. Contractors must verify all dimensions on job before commencing any work or making shop drawings. This drawing is protected by copyright.



Client: Stable Properties

Project Address:  
22 Waruda Street  
Kirribilli NSW 2061

Dwg no:  
LP04-D4422  
Title: DA  
Level 1 Landscape Plan

Drawn by:  
TB  
Issue:  
01  
Checked:  
WD  
Revision:  
L  
Scale:  
1:100 @ A2  
Date:  
29.08.2023

Dangar Barin Smith  
Landscape Design Sydney  
53 Cranbrook St, Botany

T (02) 9316 9044  
F (02) 9316 9055



